

TOUCH PRO2

Quick Start Guide

Please Read Before Proceeding

THE BATTERY IS NOT CHARGED WHEN YOU TAKE IT OUT OF THE BOX.

DO NOT REMOVE THE BATTERY PACK WHEN THE DEVICE IS CHARGING.

YOUR WARRANTY IS INVALIDATED IF YOU DISASSEMBLE OR ATTEMPT TO DISASSEMBLE THE DEVICE.

PRIVACY RESTRICTIONS

Some countries require full disclosure of recorded telephone conversations, and stipulate that you must inform the person with whom you are speaking that the conversation is being recorded. Always obey the relevant laws and regulations of your country when using the recording feature of your PDA Phone.

LIMITATION OF DAMAGES

To the maximum extent permitted by applicable law, in no event shall HTC or its providers be liable to user or any third party for any indirect, special, consequential, incidental or punitive damages of any kind in contract or tort, including, but not limited to, injury, loss of revenue, loss of goodwill, loss of business opportunity, loss of date, and/or loss of profits arising out of, or related to, in any manner, or the delivery, performance or nonperformance of obligations, or use of the weather information, stock data, data or documentation hereunder regardless of the foreseeability thereof.

FOR MORE INFORMATION

For health, safety, and regulatory information, see "Appendix: Safety and Other Notices".

Contents

1. Welcome to the HTC Touch Pro2 Quick Start Guide.....	4
2. Inside the Box.....	4
3. Get to Know Your HTC Touch Pro2.....	5
4. Installing the SIM Card, Battery, and Storage Card.....	7
5. Get Started.....	10
6. Personalize Your HTC Touch Pro2.....	14
7. Add Contacts.....	17
8. Experience People-centric Communication.....	19
9. Make Calls.....	21
10. Send Text and Multimedia Messages.....	23
11. Set Up and Use E-mail.....	24
12. Keep Track of Your Appointments.....	25
13. Make Conference Calls.....	26
14. Experience Internet Without the Wait.....	29
15. Use the Camera.....	30
16. Manage Wi-Fi, Bluetooth and Other Connections.....	32
17. Maintain the Performance of Your Device.....	34
Appendix: Safety and Other Notices.....	35

1. Welcome to the HTC Touch Pro2 Quick Start Guide

Congratulations on your purchase of the HTC Touch Pro2.

This **Quick Start Guide** will help you get started with your HTC Touch Pro2. This guide will walk you through the features we feel you will want to learn right away when you use your HTC Touch Pro2.

For a more complete guide in using your HTC Touch Pro2, please download the **User Manual PDF** from the HTC support web site:
<http://www.htc.com/www/support.aspx>.

2. Inside the Box

You should find the following items inside the box.

- HTC Touch Pro2
- Battery
- AC adapter
- Screen protector
- Wired stereo headset
- USB sync cable
- Quick Start Guide
- Extra stylus
- Pouch

3. Get to Know Your HTC Touch Pro2

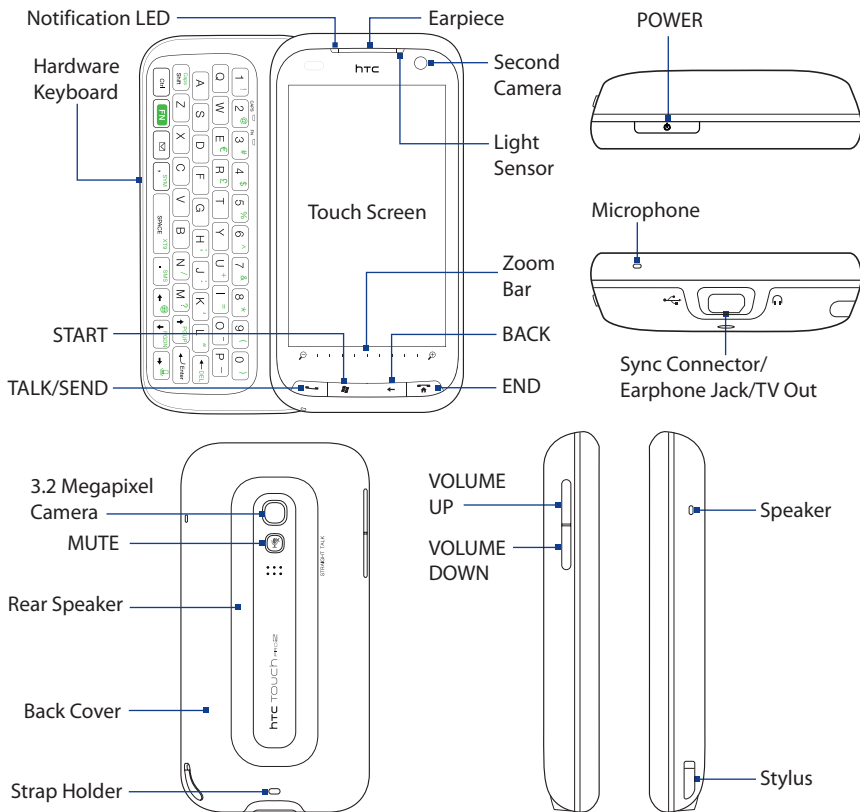

Opening the hardware keyboard

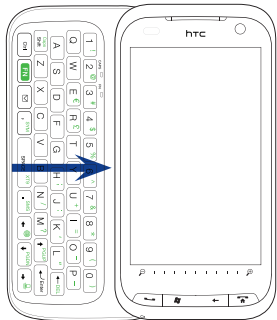

To use the hardware keyboard, slide the screen panel to the right to reveal the keyboard.

The screen orientation automatically switches to landscape mode when the keyboard is opened.

Adjusting the LCD screen angle

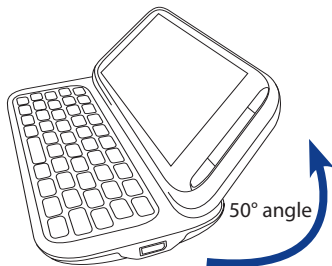

The maximum tilting angle is 50 degrees. Do not force the screen to tilt further than the maximum angle as it will break the device.

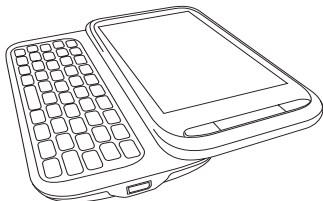

Before you retract the screen, be sure to adjust the screen angle back to the original horizontal position.

4. Installing the SIM Card, Battery, and Storage Card

You need to remove the back cover before you can install the SIM card, battery and storage card. Also, make sure to always turn off the power before installing or replacing the SIM card and battery.

To remove the back cover

1. Make sure your device is turned off.
2. Remove the stylus.
Note You need to temporarily remove the stylus to be able to remove or replace the back cover.
3. Firmly hold the device with both hands and the front panel facing down.
4. Push the back cover up with your thumbs until it disengages from the device and then slide it up to remove.

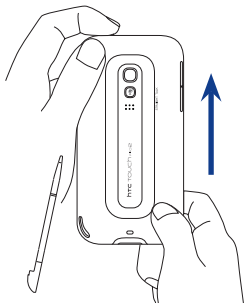

SIM card

To install the SIM card

1. Remove the battery if it is installed.
2. Locate the SIM card slot, then insert the SIM card with its gold contacts facing down and its cut-off corner facing out the card slot.
3. Slide the SIM card completely into the slot.

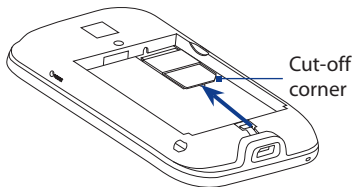

To remove the SIM card

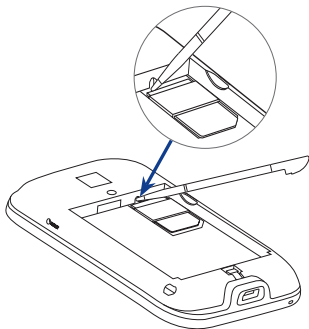

1. Insert the tip of the stylus into the small hole above the SIM card slot, and then push the SIM card out with the stylus.
2. Slide the SIM card out from the slot with your other thumb or finger.

Battery

To install the battery

1. Align the battery's exposed copper contacts with the battery connectors at the bottom part of the battery compartment.
2. Insert the contacts side of the battery first and then gently push the battery into place.
3. Replace the back cover and insert the stylus back into the stylus compartment.

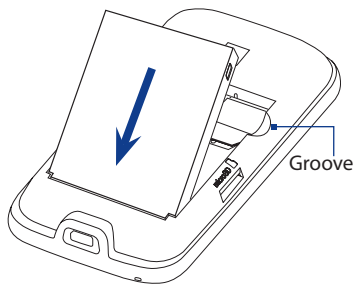

To remove the battery

Lift out the battery from the groove at the upper right side of the battery compartment.

To charge the battery

1. Connect the USB connector of the AC adapter to the sync connector at the bottom of your device.
2. Plug in the AC adapter to an electrical outlet to start charging the battery. The battery will be fully charged after about **3 hours** of charging.

Note Only the AC adapter and USB sync cable provided with your device must be used to charge the battery.

Storage card

To install the microSD card

1. Remove the stylus and then remove the back cover.
2. Locate the microSD card slot on the upper part of the exposed right panel.
3. Insert the microSD card into the slot with its gold contacts facing down until it clicks into place.

Note To remove the microSD card, press to eject it from the slot.

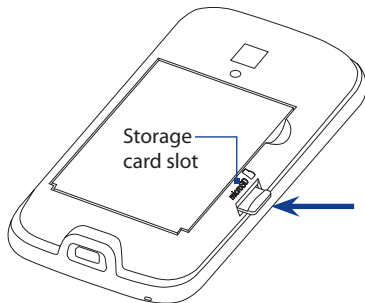

5. Get Started

After installing and charging the battery, you can now power on and start using your device.

Turning on the power

Press the POWER button on the top panel of your device.

On first time use, your device displays the **SIM Card Changed** screen which gives you the choice to auto-configure your device's data connections, such as 3G/GPRS, MMS, and WAP and import SIM contacts (if available). Follow the on-screen instructions to complete the configuration.

Using the Start screen



Touch **Start** on the top-left corner of the screen or press the START () button to open the Start screen. The Start screen gives you one-touch access to the programs and settings of your device. You can also add the shortcut icons of your favorite programs in the Start screen so you can open them quickly.

Using the TouchFLO™ 3D Home screen

Your device's main screen is the TouchFLO™ 3D Home screen which allows finger-touch access to the most important functions such as favorite contacts, text messages, e-mail, calendar, Internet, and more.

You will find the following tabs that on the TouchFLO 3D Home screen:

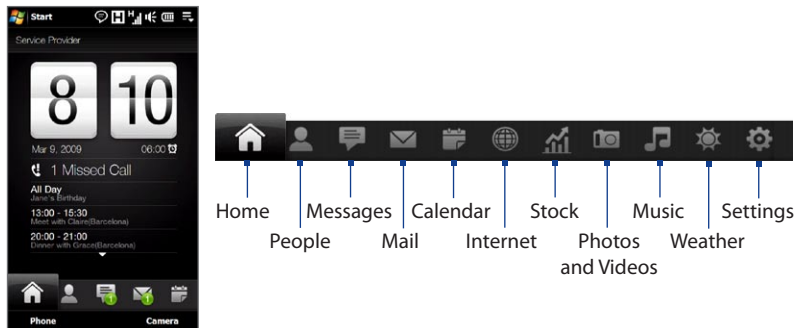

To display TouchFLO 3D in landscape view

When you slide out the hardware keyboard, the Home screen automatically changes to landscape view and temporarily hides the tabs. Touch  at the bottom left side of the Home screen to display the tabs.



To switch between the tabs of the TouchFLO 3D

Do any of the following:

- Touch or tap the desired tab.
- Press and hold your finger on the active tab, and then slide your finger right or left over the tabs..
- Swipe left or right across the screen.
- Press the right or left key on the hardware keyboard.

Tip Press the END button anytime to return to the Home tab.

Entering text

When you need to enter text, use the hardware keyboard. Another option is to use either the on-screen Full QWERTY or Phone Keypad. These two on-screen keyboards both provide large, finger-friendly keys and predictive text input.

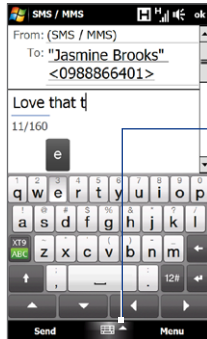

Full QWERTY

Tap this up arrow icon to open the Input Methods menu and choose an on-screen keyboard or other input method.

Tap these 4 navigation control keys for directional control.



Phone Keypad

For more information about using the hardware keyboard and on-screen keyboards, refer to the “Entering Text” chapter in the User Manual PDF.

Using the Zoom bar

The Zoom bar located below the touch screen is a handy zoom control that is unique in your HTC Touch Pro2. When you are viewing a web page or photo, you can zoom in by sliding your finger from left to right across the Zoom bar, or zoom out by sliding from right to left.

What's more, you can also instantly enlarge or shrink the text size when you open and read messages or Word documents. Slide your finger from left to right across the Zoom bar to increase the text size, or slide from right to left to decrease. To increase or decrease the text size more, slide across the Zoom bar again.

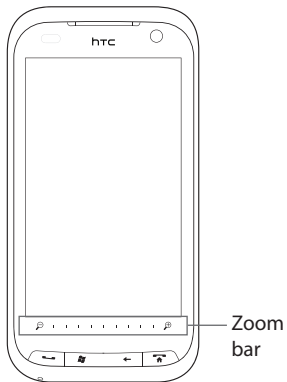

6. Personalize Your HTC Touch Pro2

Personalize your HTC Touch Pro2 to suit your lifestyle.

Date and time

If you are a frequent traveler, you can easily set your device to display the date and time of your location.

1. On the TouchFLO 3D Home tab, tap the digital clock to open the **World Clock** screen.
2. Choose the city where you are located.

If the city where you are traveling is not listed, tap **Add City** to add it to the list.

Tip Your device can also serve as your personal alarm clock. Open the World Clock screen and then tap the Alarm tab () to set the alarm time. You can set up to three alarms.

Wallpaper

Personalize the Home tab to display your personal photo.

1. Tap **Start > Settings**, and then tap **Wallpaper**. The Album program opens.
2. Finger-scroll through the available photos and then tap the desired photo.

Note If the desired photo is not displayed in Album, tap **Albums** and navigate to the folder where the photo is located.

Ring tone

Choose from the preset collection of ring tones. You can also download or copy your desired ring tone to the device.

1. Tap **Start > Settings**, and then tap **Sound**.
2. Tap **Ringtone**, select the desired ring tone in the list, and then tap **Done**.

- Tip** When downloading or copying a sound file, store the file to the /My Documents/ My Ringtones folder on your device.
- For a complete list of supported audio file formats, refer to the Appendix in the User Manual PDF.

Profile

You can select a profile for incoming calls.

1. Tap **Start > Settings**, and then tap **Sound**.
2. Under **Profiles**, choose one of the following: **Normal**, **Vibrate**, **Silent**, or **Automatic**.

My Contact Card

The first time you access the People tab, **My Contact Card** opens and lets you enter your own contact information.

To set up My Contact Card

1. On the Home screen, slide to the People tab.
2. When the My Contact Card screen appears, tap **Next**.
3. On the Add Photo screen, choose how to add your photo to your contact card. You can use the **Camera** to take your photo, or if you have a **Facebook** account, login to your account and sync with your Facebook profile.
4. Enter your information in the fields provided.
5. When finished, tap **Next**, and then tap **Done**.

Tips

- If you skipped setting up My Contact Card or if you want to edit your information, you can open My Contact Card again. On the People tab, tap **All People** and then tap **Me**.
- Tap  if you want to send My Contact Card as a vcard (.vcf) file attachment in a multimedia message.

Weather and stock information

Set up the TouchFLO 3D Weather tab to display up-to-date weather conditions of frequently-visited locations. Up to 10 cities can be displayed on this tab.

You can also get the most up-to-date stock information. Add up to 14 stock quotes or market indexes on the Stock tab.

For more information about customizing the Weather and Stock tabs, refer to the “TouchFLO 3D” chapter in the User Manual PDF.

More settings

Tap **Start > Settings** to access and customize basic settings that are available on the TouchFLO 3D Settings tab.

To access the complete settings of your device, tap **Start > Settings > All Settings**.

For more information about configuring settings, refer to the “Managing Your Device” chapter in the User Manual PDF.

7. Add Contacts

On the People tab, you can add up to 15 favorite contacts. This makes it quicker and easier for you to make calls, send text messages, and send e-mail messages to contacts who you most frequently communicate with.

Creating new contacts

Before you can add favorite contacts to the People tab, you need to create new contacts or import SIM contacts.

1. On the Home screen, slide to the People tab, tap **All People**, and then tap **New** on top of the list.
2. Enter the contact information in the fields provided.

Tip Scroll down the New Contact Card screen and then tap **More** to enter additional contact details using Windows Mobile's Contacts program. For more information, refer to the "Programs" chapter in the User Manual PDF.

3. When done, tap **OK**.

The screenshot shows the 'New Contact Card' screen with the following details:

- Name:** First: Claire, Last: Nicols
- Company:** Company: HTC Corp, Title: End-user Evaluator
- Number:** Mobile: 0900000000, Add Number +
- E-mail:** E-mail: nicksy.c@googlemai...

Tips

- On first time use of your device, if you did not import SIM contacts and you want to import them now, tap **Start** > **All Programs** > **SIM Manager**, tap **Menu** > **Select All**, and then tap **Menu** > **Save to Contacts**.
- Importing SIM contacts results in duplicate entries on the Contacts list of the People screen. To display only contacts that are stored on your device, tap **Menu** > **View** > **Contacts**.

Adding favorite contacts to the People tab

Once you have created or imported contacts, you can add them as favorite contacts to the People tab.

1. On the Home screen, slide to the People tab.
2. Tap **Add Favorite**, or tap one of the **plus (+)** icons.
3. On the Select a Contact screen, tap the name of the desired contact.
4. Select a phone number or e-mail address to associate to the favorite contact.

Note If there is no picture assigned to the contact, the next screen allows you to select or take a picture of the contact.

8. Experience People-centric Communication

Your HTC Touch Pro2 keeps all your communication at your fingertips in one convenient location.

Quick access to favorite contacts

Flip through the contact pictures on the People tab and then quickly call or send a message to a favorite contact.

Tip Another way to browse through and choose from the favorite contacts is to drag your finger up or down the picture strip at the right side of the People tab.

Tap the contact name to call the displayed phone number or send an e-mail message to the displayed e-mail address.

You can also tap one of the icons below the contact name to call the mobile phone, work phone, or home phone, or to send a text or e-mail message to the contact.



Centralized communication

Your HTC Touch Pro2 organizes all text messages, e-mail messages, and calls that you exchanged with a contact in a convenient interface.

When you tap a favorite contact on the People tab, or when you tap **All People** and then tap a contact, the **Contact Details** screen opens, with the Details tab displayed. Tap the other tabs to view your conversations with this contact.

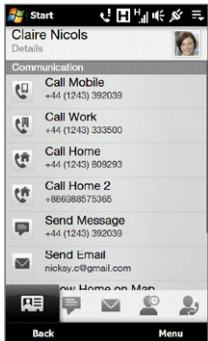

On the Details tab, choose how to communicate with the contact or edit contact details.

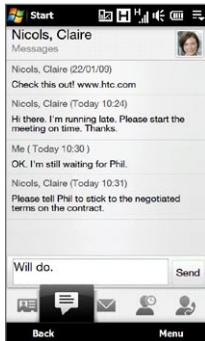

On the Messages tab, view exchanged text messages and quickly send a reply.

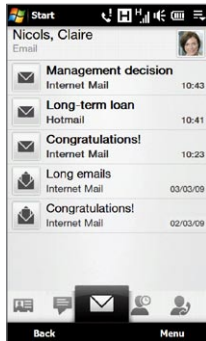

On the Email tab, view received e-mail messages from the contact.

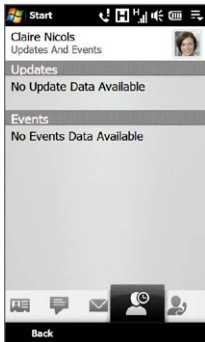

On the Updates and Events tab, view Facebook updates and new events.

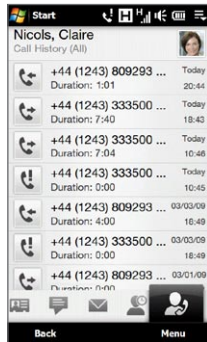

On the Call History tab, view exchanged calls and call back the contact.

9. Make Calls

When you start a call from the People tab or the Contacts list, the Phone screen opens and dials the call.

You can also open the Phone screen anytime by pressing the TALK/SEND button () on your device.

Tap to switch between voice and video call. (For more information about making video calls, refer to the “Using Phone Features” chapter in the User Manual PDF.)

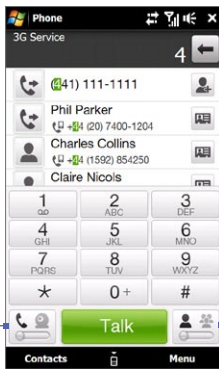

Tap to switch to conference call mode. (See “Make Conference Calls” in this Quick Start Guide for details.)

Tap the keys on the Phone screen to enter a phone number or contact name. If there are matches found from the Call History and stored contacts, tap the desired phone number or contact name from the filtered list. If there are no matches found, tap the **Talk** button or press TALK/SEND to dial the call.

Making a voice call from a message

When you select or view a text, multimedia or e-mail message, you can directly call the sender of the message.

- On the TouchFLO 3D Messages tab, Mail tab, or the Inbox, select a message and then press TALK/SEND.

The Phone screen then opens, with the sender's phone number automatically filled in and ready to be dialed. Tap **Talk** or press TALK/SEND again to call the sender.

- Open a received e-mail. You can tap the **Talk** icon () that is displayed to the right of the sender name to call the sender, if this sender is a stored contact.
- Tapping a phone number that is displayed in the body of the message also allows you to call that number.

Tip If you made a call from an e-mail message, an e-mail indicator will be shown on the **Keypad** button (). Tap this button to view the e-mail content directly on the Phone screen.

Making a voice call from a meeting request or reminder

When you receive a calendar reminder or meeting request e-mail that contains a phone number, you can tap the number to directly place the call.

For example, if you are traveling and need to join a conference bridge call back in the home office, rest assured that you can join the call without delay.

Appointment reminders you receive on your device will conveniently display the phone number and PIN, ready for you to dial.

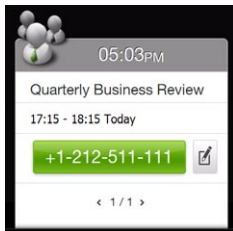

Answering calls

To answer an incoming call, fully slide the center button to the left of the Answer/Ignore bar, or press the TALK/SEND button.

To reject an incoming call, fully slide the center button to the right of the Answer/Ignore bar, or press END.

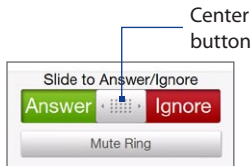

10. Send Text and Multimedia Messages

Create and send text or multimedia messages to your family, friends or business associates.

To send a text message

1. On the Home screen, slide to the Messages tab and tap .
2. In the **To** field, enter a mobile phone number, or tap **To** and select a contact from the Contacts list.
3. Compose your message and then tap **Send**.

To send a multimedia message

1. Tap **Start > All Programs > Messaging > SMS / MMS**.
2. Tap **Menu > New > MMS**, and then tap **Custom**.
3. Enter the recipient's mobile number or e-mail address in the **To** field and enter the message **Subject**.
4. Fill in the MMS message slide by tapping **Insert picture/video**, **Insert text here**, and **Insert audio**.
5. When finished, tap **Send**.

11. Set Up and Use E-mail

On the Home screen, slide to the Mail tab and set up your personal e-mail account such as Yahoo! Mail Plus or AOL and your Outlook work e-mail account.

If this is your first time to set up an e-mail account, tap **New Account**. If you are setting up subsequent accounts, tap **Menu > Accounts > New Account**. The Mail Setup screen then opens, guiding you to set up your e-mail account.

To set up an Internet e-mail account

1. On the Mail Setup screen, enter your e-mail address and password, then tap **Next**.
2. Enter your name and account display name, then tap **Next**. Mail Setup then searches for the e-mail provider settings on your device.
Note If the settings are not found, you will be prompted to enter the e-mail account settings manually. Obtain the e-mail account settings from your e-mail provider.
3. Tap the **Automatic Send/Receive** time, and then choose how frequent you want e-mail messages to be automatically sent and downloaded on your device.
4. Tap **Done**.

To set up an Outlook work e-mail account

1. On the Mail Setup screen, enter your e-mail address and password, select the **Exchange Email (Outlook)** check box, and then tap **Next**.
2. Enter the domain name and server address, select the **This server requires an encrypted (SSL) connection** option, if needed, and then tap **Next**.
3. Clear the data that you want to exclude from synchronization, and then tap **Done**. Your device then synchronizes with the Exchange Server and downloads your Outlook e-mail messages.

To create and send an e-mail message

1. E-mail accounts are displayed as small e-mail icons at the right side of the Mail tab. Select an e-mail account that you want to use.
2. Tap  to create a new e-mail.
3. Tap **To** and select a contact that has a stored e-mail address. Repeat this process to add more e-mail addresses of your contacts.
4. Enter your e-mail subject and message, then tap **Send**.

12. Keep Track of Your Appointments

Keep track of your important appointments by adding them on the Calendar tab. To add a new appointment, tap **Start > Calendar** to open the Calendar tab, tap **New**, and then enter your appointment details.

On the Calendar tab, dates with appointments are indicated by a triangle () at the upper-left corner of the date box.



Month view



Day view

13. Make Conference Calls

Setting up a conference call is as easy as tapping names, phone numbers or photos of your participants.

Note Not all mobile phone networks support conference calling. Contact your wireless service provider for details.

To start a conference call from the Phone screen

1. Press TALK/SEND to open the Phone screen.
2. Tap  to switch to conference mode.
3. Choose participants by selecting the check boxes of contacts or phone numbers, then tap **Conference**.

The participants list is then displayed.

Tip To remove a participant before starting the conference call, tap **Keypad** and clear the check box of that participant.

4. Slide open the hardware keyboard so that your device will display the Conference Room screen.
5. Tap the photo of the first participant.
6. When the first call is connected, tap the photo of the second participant to dial the second call. The first call is automatically put on hold.
7. When the second call is connected, tap the **Join** button () to add it to the conference call and then dial the next participant.

Repeat this same process until all participants are added and connected to the conference call.



To start a conference call from an e-mail

1. On the Home screen, slide to the Mail tab.
2. Browse through received messages, and then tap an e-mail message to open it.
3. Tap the **To** or **Cc** button to open the Call screen.
4. Select the check boxes of the sender and recipients who you want to join in your conference call and then tap **Conference**.
5. Do steps 4 to 6 in "To start a conference call from the Phone screen" to dial each participant and add each connected call to your conference call.

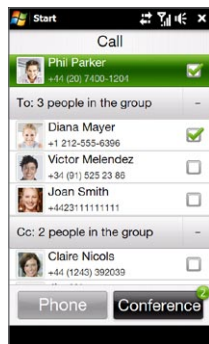

To break away from the conference call

During the conference call, you can talk in private with a certain participant and put the others in the conference on hold. Tap the participant's photo and then tap **Private**.

To swap between a private call and the conference call, tap the dim area or tap **Swap**.

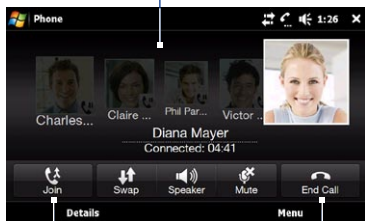
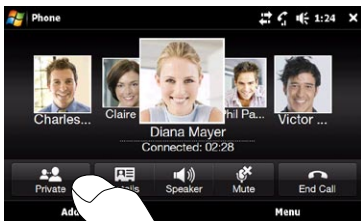

Tap **Join** to add a private call back to the conference call.

Tap **End Call** to end a private call and return to the conference call.

To turn on the speakerphone

While a call or conference call is in progress, you can turn on the speakerphone by simply placing your device face down.

Featuring Straight Talk™ technology, your device provides crystal-clear sound quality and voice reception during conference calls. When the speakerphone is on, your device also enables the dual microphone to enhance your voice quality and reduce noise.

To end the conference call

Tap **End Call** or press END.

For more information about conference calling, refer to the “Using Phone Features” chapter in the User Manual PDF.

14. Experience Internet Without the Wait

Set up push Internet on your device so that you can have frequently-visited web pages pre-delivered and ready for display on the Opera Mobile browser anytime.

To add a push web page to the Internet tab

1. On the Internet tab, tap **Add a new push page**.
2. Select a bookmark, or enter the push web page title and address (URL).
3. Select the auto update time under **Frequency**.
4. Tap **Save**.

To automatically update your push web pages

1. On the Internet tab, touch **Menu > Schedule Settings**.
2. Under the **Day** and **Time** section, select the day or days to auto update the push web pages. Also specify the update time.
3. Scroll down the screen to the **Frequency** section, then touch the update time below each of your push web pages to set the time interval for automatic updates.
4. Tap **Done**.

Tip To turn off the Push Internet feature or configure other related settings, tap **Menu > Data Settings**.

15. Use the Camera

Whether you are traveling on business or leisure, you can use the built-in 3.2 megapixel camera to take high-quality photos or capture video clips of your trip and encounters.

To take a photo

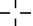
1. On the Home screen, slide to the Photos and Videos tab and then tap the camera icon ().
2. Touch the area on the viewfinder screen that you want to focus on. The Touch Focus indicator () positions itself on the selected area.

Note If you tap outside the effective focus area, a white box appears to indicate the area where you can use Touch Focus.

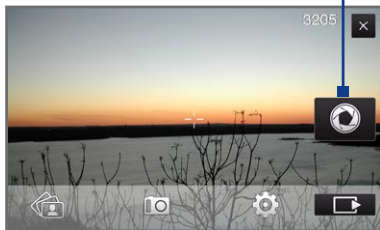

3. Touch the **Virtual Camera** button () to activate auto-focus on the selected area and automatically take the photo.

Virtual Camera button



Tip To move the Touch Focus indicator back to the center of the screen, tap  .

To capture a video clip

1. On the Home screen, slide to the Photos and Videos tab and then tap the video icon ()
2. Point the camera at your subject.
3. Touch the **Virtual Camera** button () to activate auto-focus. When focus is set, the camera automatically starts capturing video. To stop capturing, touch the **Virtual Camera** button again.

To learn more about using the camera and other multimedia features of your device, refer to the “Camera and Multimedia” chapter in the User Manual PDF.

To view photos and videos

Use the Photos and Videos tab or the Album program to browse through your photos and videos and view them on the screen.

For more information, refer to the “TouchFLO 3D” and “Camera and Multimedia” chapters in the User Manual PDF.

16. Manage Wi-Fi, Bluetooth and Other Connections

Your HTC Touch Pro2 supports both wireless and wired connections.

Using the Comm Manager

Comm Manager lets you easily turn on and off the wireless communication features of your device such as Wi-Fi, Bluetooth, the phone connection, and data connection. To open Comm Manager, tap **Start > Settings**, and then tap **Communications**.

On the Comm Manager screen, tap the left side to configure the listed settings. Tap the OFF/ON slider on the right to turn a function on or off.

For more information about using Wi-Fi and connecting to a wireless network, refer to the “Internet” chapter in the User Manual PDF.

For information about connecting a Bluetooth headset, refer to the “Bluetooth” chapter in the User Manual PDF.

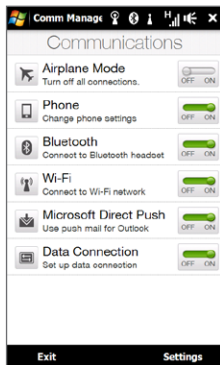

Connecting your device to a computer

Whenever you connect your device to the computer with the USB cable, the **Connect to PC** screen displays and prompts you to choose the type of connection you want to use.

ActiveSync

Select this mode when you need to sync information and files between your device and your computer. For more information, refer to the “Synchronizing Information” chapter in the User Manual PDF.

Disk Drive

This mode is available for selection only when there is a microSD card installed on your device. Select this mode when you want to quickly copy files between the storage card and your computer.

Internet Sharing

When you do not have Internet access on your notebook or desktop computer, you can select this mode to use your device as a modem for your computer. For more information about using Internet Sharing, refer to the “Internet” chapter in the User Manual PDF.

17. Maintain the Performance of Your Device

If you experience some sluggishness with your device, try a soft reset to shut down all programs and restart your device.

To perform a soft reset

1. Pull out the stylus.
2. Remove the back cover. For instructions, see “To remove the back cover” in this Quick Start Guide.
3. Use the stylus tip to press the RESET button located at the upper-left side of the open back panel.

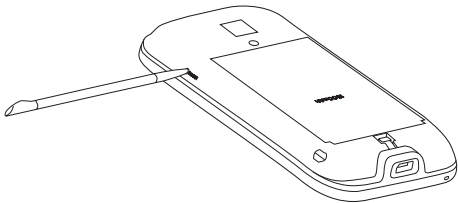

Your device then restarts.

4. Replace the back cover and insert the stylus back into its compartment.

Note Refer to the “Managing Your Device” chapter in the User Manual PDF if you need instructions on performing a clear storage or hard reset. **Please be informed that after performing either action, all your data will be deleted and your device will be set back to factory default settings.** Make sure you back up first any additional installed programs, your data, and your files before you perform either action.

Appendix: Safety and Other Notices

Disclaimers

THE WEATHER INFORMATION, STOCK DATA, DATA AND DOCUMENTATION ARE PROVIDED "AS IS" AND WITHOUT WARRANTY OR TECHNICAL SUPPORT OF ANY KIND FROM HTC. TO THE MAXIMUM EXTENT PERMITTED BY APPLICABLE LAW, HTC AND ITS AFFILIATES expressly disclaim any and all representations and warranties, express or implied, arising by law or otherwise, regarding the Weather Information, Stock Data, Data, Documentation, or any other Products and services, including without limitation any express or implied warranty of merchantability, express or implied warranty of fitness for a particular purpose, non-infringement, quality, accuracy, completeness, effectiveness, reliability, usefulness, that the Weather Information, Stock Data, Data and/or Documentation will be error-free, or implied warranties arising from course of dealing or course of performance.

Without limiting the foregoing, it is further understood that HTC and its Providers are not responsible for Your use or misuse of the Weather Information, Stock Data, Data and/or Documentation or the results from such use. HTC and its Providers make no express or implied warranties, guarantees or affirmations that weather information will occur or has occurred as the reports, forecasts, data, or information state, represent or depict and it shall have no responsibility or liability whatsoever to any person or entity, parties and non-parties alike, for any inconsistency, inaccuracy, or omission for weather or events predicted or depicted, reported, occurring or occurred. WITHOUT LIMITING THE GENERALITY OF THE FOREGOING, YOU ACKNOWLEDGE THAT THE WEATHER INFORMATION, STOCK DATA, DATA AND/OR DOCUMENTATION MAY INCLUDE INACCURACIES AND YOU WILL USE COMMON SENSE AND FOLLOW STANDARD SAFETY PRECAUTIONS IN CONNECTION WITH THE USE OF THE WEATHER INFORMATION, STOCK DATA, DATA OR DOCUMENTATION.

Important Health Information and Safety Precautions

When using this product, the safety precautions below must be taken to avoid possible legal liabilities and damages.

Retain and follow all product safety and operating instructions. Observe all warnings in the operating instructions on the product.

To reduce the risk of bodily injury, electric shock, fire, and damage to the equipment, observe the following precautions.

ELECTRICAL SAFETY

This product is intended for use when supplied with power from the designated battery or power supply unit. Other usage may be dangerous and will invalidate any approval given to this product.

SAFETY PRECAUTIONS FOR PROPER GROUNDING INSTALLATION

CAUTION: Connecting to an improperly grounded equipment can result in an electric shock to your device.

This product is equipped with a USB Cable for connecting with desktop or notebook computer. Be sure your computer is properly grounded (earthed) before connecting this product to the computer. The power supply cord of a desktop or notebook computer has an equipment-grounding conductor and a grounding plug. The plug must be plugged into an appropriate outlet which is properly installed and grounded in accordance with all local codes and ordinances.

SAFETY PRECAUTIONS FOR POWER SUPPLY UNIT

- **Use the correct external power source**

A product should be operated only from the type of power source indicated on the electrical ratings label. If you are not sure of the type of power source required, consult your authorized service provider or local power company. For a product that operates from battery power or other sources, refer to the operating instructions that are included with the product.

- **Handle battery packs carefully**

This product contains a Li-ion or Li-ion Polymer battery. There is a risk of fire and burns if the battery pack is handled improperly. Do not attempt to open or service the battery pack. Do not disassemble, crush, puncture, short external contacts or circuits, dispose of in fire or water, or expose a battery pack to temperatures higher than 60°C (140°F).



WARNING: Danger of explosion if battery is incorrectly replaced. To reduce risk of fire or burns, do not disassemble, crush, puncture, short external contacts, expose to temperature above 60° C (140° F), or dispose of in fire or water. Replace only with specified batteries. Recycle or dispose of used batteries according to the local regulations or reference guide supplied with your product.



Li-ion



- **Take extra precautions**

- Keep the battery or device dry and away from water or any liquid as it may cause a short circuit.
- Keep metal objects away so they don't come in contact with the battery or its connectors as it may lead to short circuit during operation.
- The phone should only be connected to products that bear the USB-IF logo or have completed the USB-IF compliance program.

- Do not use a battery that appears damaged, deformed, or discolored, or the one that has any rust on its casing, overheats, or emits a foul odor.
- Always keep the battery out of the reach of babies and small children, to avoid swallowing of the battery. Consult the doctor immediately if the battery is swallowed.
- If the battery leaks:
 - Do not allow the leaking fluid to come in contact with skin or clothing. If already in contact, flush the affected area immediately with clean water and seek medical advice.
 - Do not allow the leaking fluid to come in contact with eyes. If already in contact, DO NOT rub; rinse with clean water immediately and seek medical advice.
 - Take extra precautions to keep a leaking battery away from fire as there is a danger of ignition or explosion.

SAFETY PRECAUTIONS FOR DIRECT SUNLIGHT

Keep this product away from excessive moisture and extreme temperatures. Do not leave the product or its battery inside a vehicle or in places where the temperature may exceed 60°C (140°F), such as on a car dashboard, window sill, or behind a glass that is exposed to direct sunlight or strong ultraviolet light for extended periods of time. This may damage the product, overheat the battery, or pose a risk to the vehicle.

PREVENTION OF HEARING LOSS



CAUTION: Permanent hearing loss may occur if earphones or headphones are used at high volume for prolonged periods of time.

NOTE: For France, Earphone (listed below) for this device have been tested to comply with the Sound Pressure Level requirement laid down in the applicable NF EN 50332-1:2000 and/or NF EN 50332-2:2003 standards as required by French Article L. 5232-1.

- Earphone, manufactured by HTC, Model HS S300.

SAFETY IN AIRCRAFT

Due to the possible interference caused by this product to an aircraft's navigation system and its communications network, using this device's phone function on board an airplane is against the law in most countries. If you want to use this device when on board an aircraft, remember to turn off your phone by switching to Airplane Mode.

ENVIRONMENT RESTRICTIONS

Do not use this product in gas stations, fuel depots, chemical plants or where blasting operations are in progress, or in potentially explosive atmospheres such as fuelling areas, fuel storehouses, below deck on boats, chemical plants, fuel or chemical transfer or storage facilities, and areas where the air contains chemicals or particles, such as grain, dust, or metal powders. Please be aware that sparks in such areas could cause an explosion or fire resulting in bodily injury or even death.

EXPLOSIVE ATMOSPHERES

When in any area with a potentially explosive atmosphere or where flammable materials exist, the product should be turned off and the user should obey all signs and instructions.

Sparks in such areas could cause an explosion or fire resulting in bodily injury or even death. Users are advised not to use the equipment at refueling points such as service or gas stations, and are reminded of the need to observe restrictions on the use of radio equipment in fuel depots, chemical plants, or where blasting operations are in progress. Areas with a potentially explosive atmosphere are often, but not always, clearly marked. These include fueling areas, below deck on boats, fuel or chemical transfer or storage facilities, and areas where the air contains chemicals or particles, such as grain, dust, or metal powders.

ROAD SAFETY

Vehicle drivers in motion are not permitted to use telephony services with handheld devices, except in the case of emergency. In some countries, using hands-free devices as an alternative is allowed.

SAFETY PRECAUTIONS FOR RF EXPOSURE

- Avoid using your phone near metal structures (for example, the steel frame of a building).
- Avoid using your phone near strong electromagnetic sources, such as microwave ovens, sound speakers, TV and radio.
- Use only original manufacturer-approved accessories, or accessories that do not contain any metal.
- Use of non-original manufacturer-approved accessories may violate your local RF exposure guidelines and should be avoided.

INTERFERENCE WITH MEDICAL EQUIPMENT FUNCTIONS

This product may cause medical equipment to malfunction. The use of this device is forbidden in most hospitals and medical clinics.

If you use any other personal medical device, consult the manufacturer of your device to determine if they are adequately shielded from external RF energy. Your physician may be able to assist you in obtaining this information.

Turn your phone OFF in health care facilities when any regulations posted in these areas instruct you to do so. Hospitals or health care facilities may be using equipment that could be sensitive to external RF energy.

HEARING AIDS

Some digital wireless phones may interfere with some hearing aids. In the event of such interference, you may want to consult your service provider, or call the customer service line to discuss alternatives.

NONIONIZING RADIATION

Your device has an internal antenna. This product should be operated in its normal-use position to ensure the radiative performance and safety of the interference. As with other mobile radio transmitting equipment, users are advised that for satisfactory operation of the equipment and for the safety of personnel, it is recommended that no part of the human body be allowed to come too close to the antenna during operation of the equipment.

Use only the supplied integral antenna. Use of unauthorized or modified antennas may impair call quality and damage the phone, causing loss of performance and SAR levels exceeding the recommended limits as well as result in non-compliance with local regulatory requirements in your country.

To assure optimal phone performance and ensure human exposure to RF energy is within the guidelines set forth in the relevant standards, always use your device only in its normal-use position. Contact with the antenna area may impair call quality and cause your device to operate at a higher power level than needed. Avoiding contact with the antenna area when the phone is IN USE optimizes the antenna performance and the battery life.

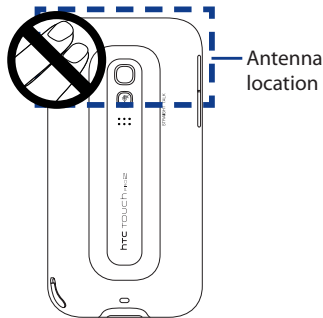

General Precautions

- **Avoid applying excessive pressure to the device**

Do not apply excessive pressure on the screen and the device to prevent damaging them and remove the device from your pants' pocket before sitting down. It is also recommended that you store the device in a protective case and only use the device stylus or your finger when interacting with the touch screen. Cracked display screens due to improper handling are not covered by the warranty.

- **Device getting warm after prolonged use**

When using your device for prolonged periods of time, such as when you're talking on the phone, charging the battery or browsing the web, the device may become warm. In most cases, this condition is normal and therefore should not be interpreted as a problem with the device.

- **Heed service markings**

Except as explained elsewhere in the Operating or Service documentation, do not service any product yourself. Service needed on components inside the device should be done by an authorized service technician or provider.

- **Damage requiring service**

Unplug the product from the electrical outlet and refer servicing to an authorized service technician or provider under the following conditions:

- Liquid has been spilled or an object has fallen onto the product.
- The product has been exposed to rain or water.
- The product has been dropped or damaged.
- There are noticeable signs of overheating.
- The product does not operate normally when you follow the operating instructions.

- **Avoid hot areas**

The product should be placed away from heat sources such as radiators, heat registers, stoves, or other products (including amplifiers) that produce heat.

- **Avoid wet areas**

Never use the product in a wet location.

- **Avoid using your device after a dramatic change in temperature**

When you move your device between environments with very different temperature and/or humidity ranges, condensation may form on or within the device. To avoid damaging the device, allow sufficient time for the moisture to evaporate before using the device.

NOTICE: When taking the device from low-temperature conditions into a warmer environment or from high-temperature conditions into a cooler environment, allow the device to acclimate to room temperature before turning on power.

- **Avoid pushing objects into product**

Never push objects of any kind into cabinet slots or other openings in the product. Slots and openings are provided for ventilation. These openings must not be blocked or covered.

- **Mounting accessories**

Do not use the product on an unstable table, cart, stand, tripod, or bracket. Any mounting of the product should follow the manufacturer's instructions, and should use a mounting accessory recommended by the manufacturer.

- **Avoid unstable mounting**

Do not place the product with an unstable base.

- **Use product with approved equipment**

This product should be used only with personal computers and options identified as suitable for use with your equipment.

- **Adjust the volume**

Turn down the volume before using headphones or other audio devices.

- **Cleaning**

Unplug the product from the wall outlet before cleaning. Do not use liquid cleaners or aerosol cleaners. Use a damp cloth for cleaning, but NEVER use water to clean the LCD screen.

Regulatory Agency Identifications

For regulatory identification purposes, your product is assigned a model number of **RHOD100**.

To ensure continued reliable and safe operation of your device, use only the accessories listed below with your **RHOD100**.

The Battery Pack has been assigned a model number of **RHOD160**.

Note This product is intended for use with a certified Class 2 Limited Power Source, rated 5 Volts DC, maximum 1 Amp power supply unit.

Telecommunications & Internet Association (TIA)

Safety Information

Pacemakers

The Health Industry Manufacturers Association recommends that a minimum separation of six inches be maintained between a handheld wireless phone and a pacemaker to avoid potential interference with the pacemaker. These recommendations are consistent with the independent research by and recommendations of Wireless Technology Research. Persons with pacemakers:

- Should ALWAYS keep the phone more than six inches from their pacemaker when the phone is turned ON.
- Should not carry the phone in a breast pocket.
- Should use the ear opposite the pacemaker to minimize the potential for interference. If you have any reason to suspect that interference is taking place, turn the phone OFF immediately.

Hearing Aids

Some digital wireless phones may interfere with some hearing aids. In the event of such interference, you may want to consult your service provider, or call the customer service line to discuss alternatives.

Other Medical Devices

If you use any other personal medical device, consult the manufacturer of your device to determine if they are adequately shielded from external RF energy. Your physician may be able to assist you in obtaining this information.

Turn the phone OFF in health care facilities when any regulations posted in these areas instruct you to do so. Hospitals or health care facilities may be using equipment that could be sensitive to external RF energy.

WEEE Notice

The Directive on Waste Electrical and Electronic Equipment (WEEE), which entered into force as European law on 13th February 2003, resulted in a major change in the treatment of electrical equipment at end-of-life.

The purpose of this Directive is, as a first priority, the prevention of WEEE, and in addition, to promote the reuse, recycling and other forms of recovery of such wastes so as to reduce disposal.



The WEEE logo (shown at the left) on the product or on its box indicates that this product must not be disposed of or dumped with your other household waste. You are liable to dispose of all your electronic or electrical waste equipment by relocating over to the specified collection point for recycling of such hazardous waste. Isolated collection and proper recovery of your electronic and electrical waste equipment at the time of disposal will allow us to help conserving natural resources. Moreover, proper recycling of the electronic and electrical waste equipment will ensure safety of human health and environment. For more information about electronic and electrical waste equipment disposal, recovery, and collection points, please contact your local city center, household waste disposal service, shop from where you purchased the equipment, or manufacturer of the equipment.

RoHS Compliance

This product is in compliance with Directive 2002/95/EC of the European Parliament and of the Council of 27 January 2003, on the restriction of the use of certain hazardous substances in electrical and electronic equipment (RoHS) and its amendments.